



# PRO-COAT FINISH EXCLUSIVE TO MACNEIL



## ***GUARANTEED CORROSION-RESISTANT FINISH***

*All MacNeil's steel superstructure components are treated with a Pro-Coat finish  
and backed by a multi-year warranty against corrosion.*

### ***Pro-Coat***

Combines two powder coatings. The 3M™ epoxy powder base coat provides corrosion protection and resists chemicals, wastewater, detergents and salt water. The glossy polyester resin top coat easily wipes clean.





### Features

- Resistant to over 100 chemicals including salt, soap & detergent
- Glossy surface resists mineral build-up and is easy to clean and maintain
- Using Pro-Coat allows MacNeil to build equipment out of high-strength steel for long lasting durability

### Customize your Tunnel Branding

- Pro-coat is available in standard silver-grey or black, or custom red, blue or yellow finish

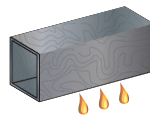

#### 1. BLAST & PREHEAT

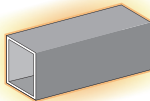

#### 2. APPLY 3M EPOXY

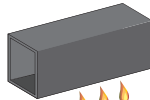

#### 3. BAKE

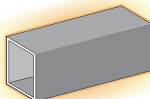

#### 4. APPLY POLYESTER RESIN

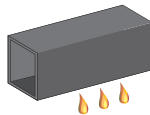

#### 5. POST BAKE

### Pro-Coat Application Process

1. Steel is sandblasted and pre-heated to 475°F.
2. 3M™ epoxy powder is applied with electrostatic spray equipment. The heat of the steel turns the powder to a gel.
3. Steel is baked again and then a polyester resin powder is applied.
4. Steel is baked for the final time and then allowed to cool. The powders gel, harden and bond to the steel.
5. Result: a uniform and attractive finish made to withstand years of use in a car wash.

### Affordable, Unbeatable Car Wash Equipment

For more than 30 years, MacNeil Wash Systems has provided superior car wash equipment to the tunnel car wash industry, automotive dealers, fleet and rental markets. Our turnkey systems, profit-boosting add-ons and cost-effective retrofits deliver a consistently superior clean with lower maintenance, higher throughput and greater revenue opportunity. Today, MacNeil equipment is more affordable than ever. Put us to the test.

MacNeil reserves the right to revise designs, make corrections, add or delete features and change specifications at any time without notice or obligation. Information provided is for reference only and is not to be used for installation or construction purposes. Refer to MacNeil Wash Systems' equipment drawings for installation specifications



**OUTLASTS AND OUTSHINES THE REST.**  
MacNeilWash.com 800.361.7797