

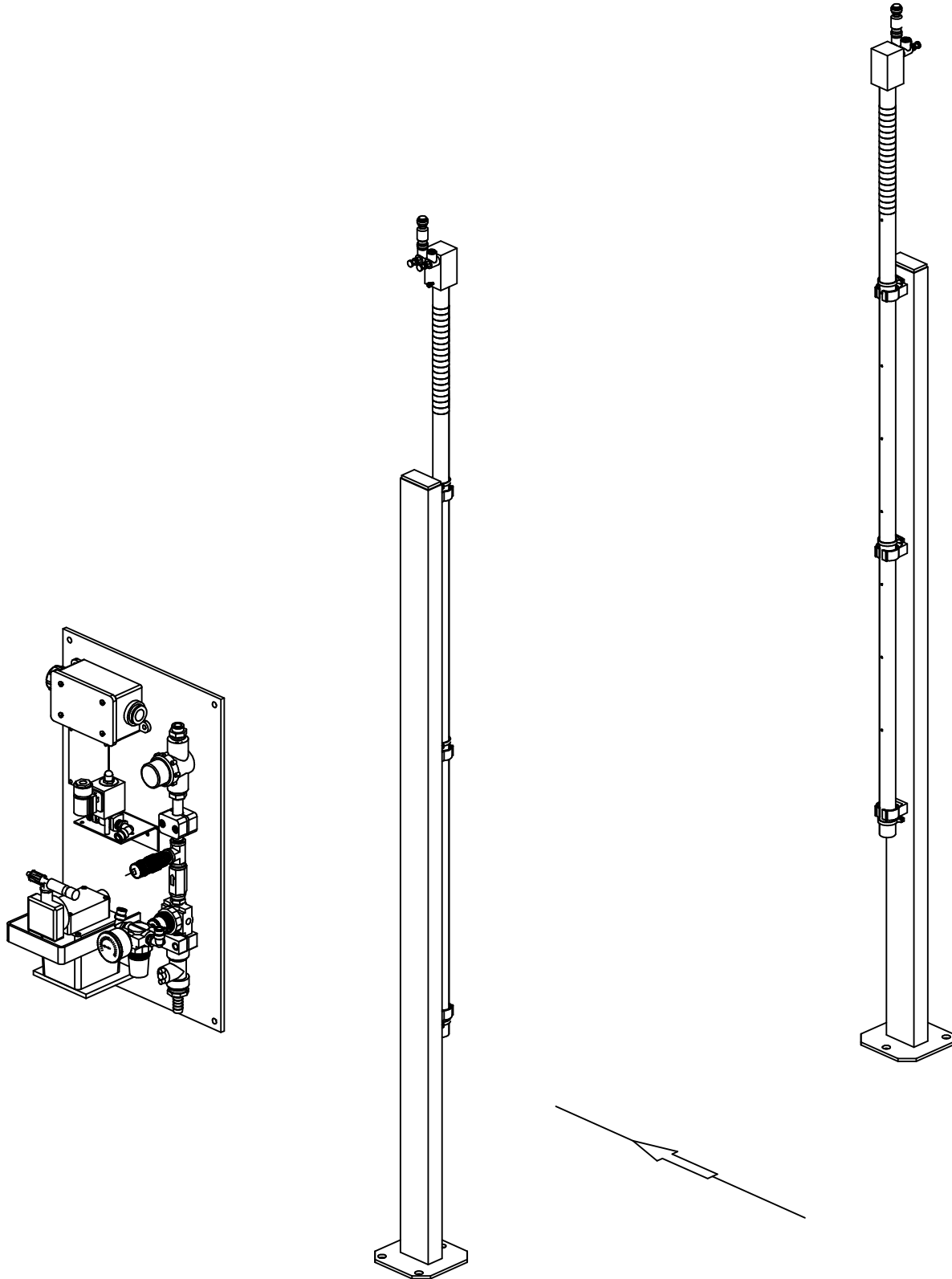

RW-118 Single Foamer



SHOWN WITH OPTIONAL POST

JANUARY 2005

RW-118

SINGLE FOAMER

JANUARY 2005

2
OF 4

DIRECTION OF FLOW
FOR ITEM #33 (90-141-01-PP)
FARMINGTON ENG NO. 6212-24NC
2 IS IN, 1 IS EXHAUST

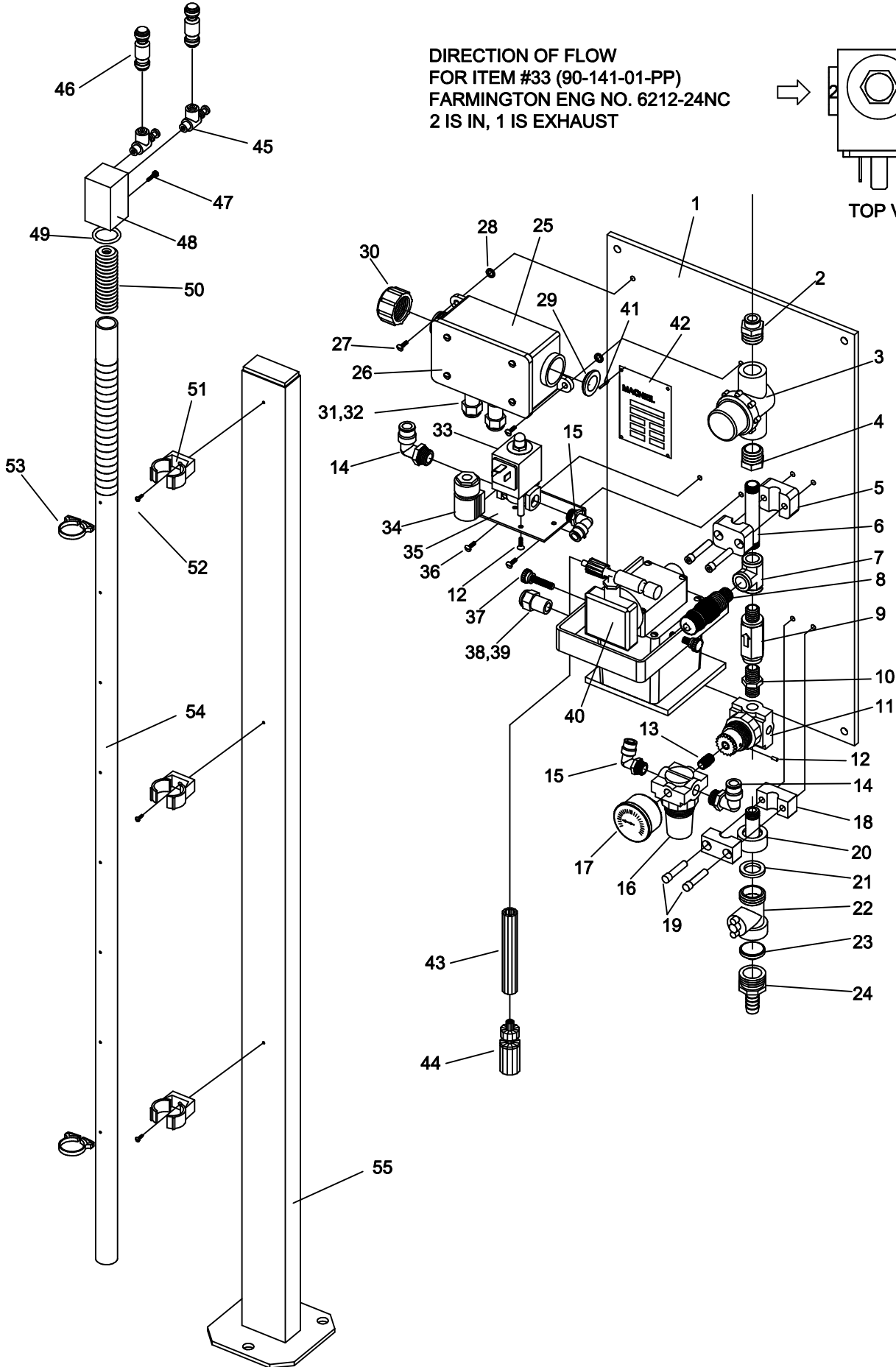
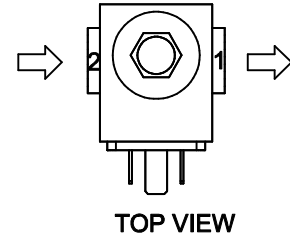

RW-118

SINGLE FOAMER

JANUARY '05
PAGE #3

Item no.	Req'd	Description	Part no.	Remarks
1	1	Single Foamer Panel Board	45-250-00-MP	
2	1	3/8" Tube x 1/2" NPT Straight	90-230-09-PP	
3	1	1/2" Line Strainer	90-058-00-PP	
4	1	1/2"NPT - 1/4"NPT Brass Bushing	90-030-02-PP	
5	1	1/2" Dia Single Hose Mounting Block	90-156-00-PP	
6	1	1/4"NPT x 3" Brass Nipple	90-216-03-PP	
7	1	1/4 NPT Female Brass Tee	90-009-04-PP	
8	1	Injector Nozzle	-----	Supplied with pump
9	1	1/4 NPT Check Valve 326-110	90-148-04-PP	
10	1	1/4 NPT Hex Nipple - Brass	90-212-02-PP	
11	1	Modified Watts Air Regulator R25-02BK	90-110-02-MP	
12	3	M4 Phil Head Mach. Screw 8mm lg.	83-504-008-SMC	
13	1	1/8 NPT Close Nipple	44-561-09-PP	
14	2	1/4 NPT - 3/8 Tube Swivel Elbow	90-225-07-PP	
15	2	1/4 NPT - 1/4 Tube Swivel Elbow	90-223-06-PP	
16	1	Watts Air Regulator R25-02B	90-110-01-PP	
17	1	Pressure Gauge 0-60 psi	90-060-00-PP	
18	1	1/4" Dia Single Hose Mount Modified	90-156-00-MP	
19	4	1/4-20 SS SHCS 1 1/4"LG	82-704-020-SIC	
20	1	3/4" GHT - 1/4 NPT Swivel Connector	90-026-04-PP	
21	1	Garden Hose Washer	90-202-00-PP	
22	1	Garden Hose Valve 65.R01500	90-139-00-PP	
23	1	Garden Hose Washer with Screen	90-202-01-PP	
24	1	1/2" GHT-1/2" Hose Barb Connector	90-028-00-PP	
25	2	Single Electrical Box	45-660-00-MP	
26	1	Single Electrical Box Cover	70-201-00-PP	
27	4	10-24 X 1/2" Pan Head Screw Phil	83-510-008-SNC	
28	2	1/4" Flat Washer Ss	80-104-000-SI	
29	1	3/4" PVC Plug	90-054-00-PP	
30	1	Strain Relief SRC 10/15	70-900-00-PP	
31	2	1/2" Strain Relief	90-056-08-PP	
32	2	1/2" Nylon Nut	84-008-000-NIN	
33a	1	Air Solenoid Valve, 24Volt, N/C	90-141-01-PP	With 24V pumps
33b	1	Air Solenoid Valve, 110Volt, N/C	90-141-03-PP	With 110V pumps
34	1	Din Plug 2508	70-610-00-PP	
35	1	2 Position Air Solenoid Bracket	49-017-00-MP	

RW-118

SINGLE FOAMER

PAGE #4

<i>Item no.</i>	<i>Req'd</i>	<i>Description</i>	<i>Part no.</i>	<i>Remarks</i>
36	2	10-24 X 3/8" Pan Head Screw Phil	83-510-006-SNC	
37	2	1/4-20 x 1" Thumb Screw, Nylon	83-804-016-NIC	With pumps 40a and 40b only
38	1	1/2" Strain Relief	90-056-08-PP	With pumps 2c,2d,2e,2f only
39	1	1/2" Nylon Nut	84-008-000-NIN	With pumps 2c,2d,2e,2f only
40	1	Low Volume Soap Pump (Specify)		
40a		JUNIOR 24V, 1.7 oz/min	70-500-00-PP	
40b		JUNIOR 110V, 1.7 oz/min	70-500-01-PP	
40c		24V, 3.1 oz/min	70-500-02-PP	
40d		110V, 3.1 oz/min	70-500-03-PP	
40e		24V, 5.9 oz/min	70-500-04-PP	
40f		110V, 5.9 oz/min	70-500-05-PP	
41	4	1/8" x 3/8" Pop Rivet	87-002-000-ZI	
42	1	Serial Identification Tag	36-900-00-PP	
43	1	Pump Foot Valve Weight	70-500-10-MP	
44	1	Foot Valve	-----	Supplied with pump
45	4	Throttle Valve	90-149-00-PP	
46	2	3/8" Check Valve	90-148-02-PP	
47	2	10-24 x 1/2" Thumb Screw	83-810-008-NNC	
48	2	Universal Mixing Block	45-420-01-PP	
49	2	O-Ring 1 1/4" 568-124	90-450-00-PP	
50	2	Foamer Sponge	45-050-00-PP	
51	6	Clamp - Click #32	90-259-03-PP	
52	6	8-32 x 1/2" SCRW PN PHL SS	83-508-008-SNC	
53	4	Clamp HO-28	52-040-05-PP	
54	2	Single Foamer Tube	45-440-00-MP	
55	2	Single Foamer Post – Silver Grey	58-100-00-SG	Optional