

**DOCUMENT #EPL-IR110**

**INCLUDES:**

**26-S10-00 SINGLE VEHICLE DETECTOR IR110-1**

**26-S20-00 DOUBLE VEHICLE DETECTOR IR110-2**

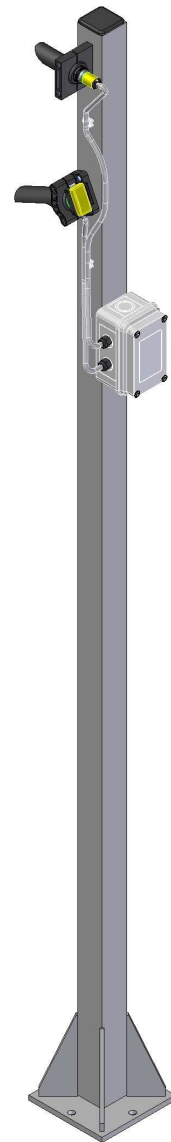
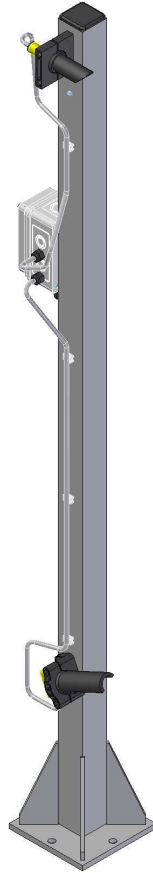

## 26-S10-00 LH SHORT POST EXPLOSION

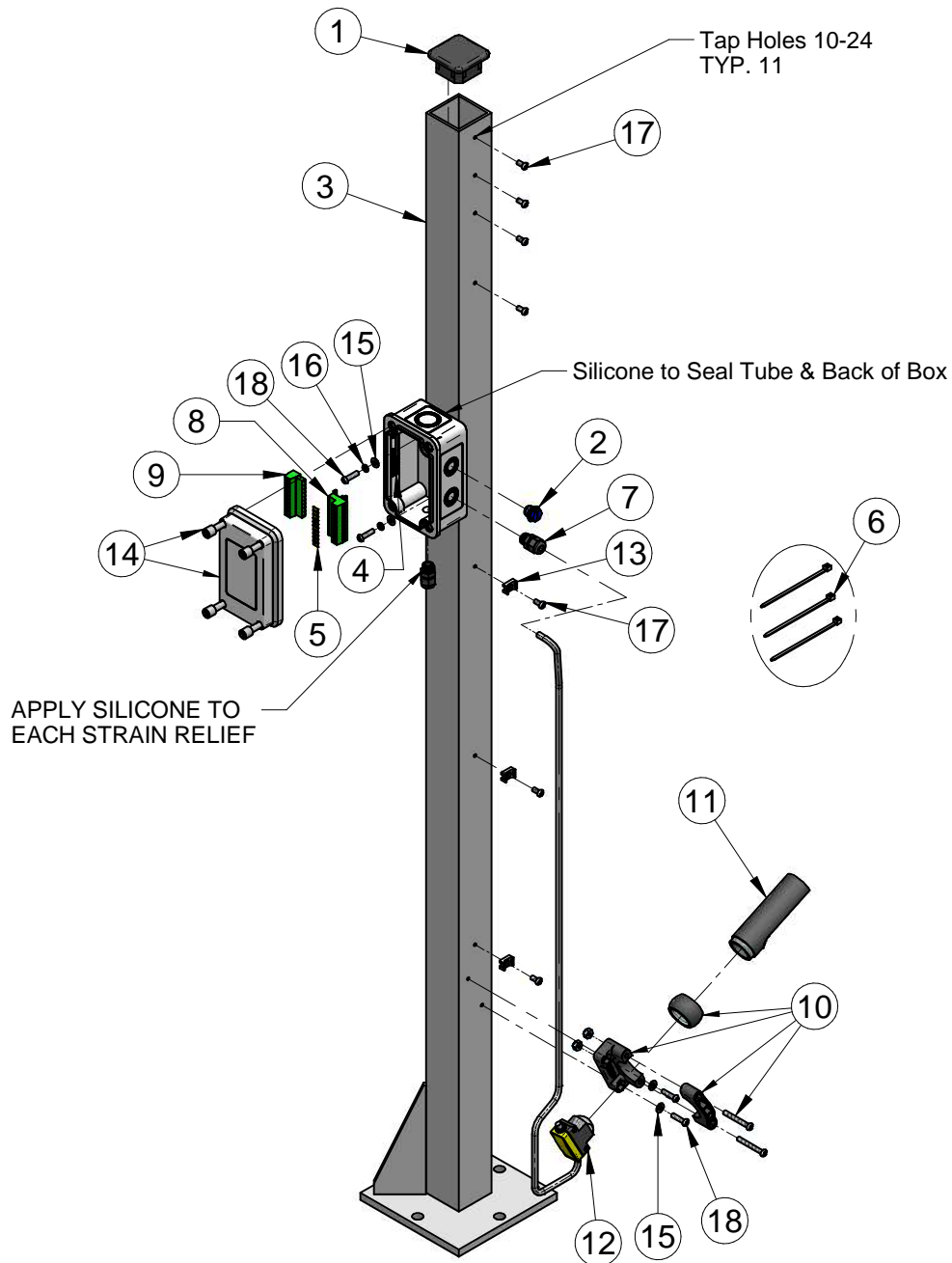

## 26-S10-00 LH SHORT POST PARTS LIST

REF.	DESCRIPTION	PART NUMBER	QTY
1	2"x2" END CAP	26-015-00-PP	1
2	THREADED PLUG 1/2"-20 (B-4)	26-015-01-PP	1
3	VEHICLE DETECTOR POST-SHORT AL	26-020-00-SG	1
4	DECAL TEST INSPECTION TAG FOR CONTROLLERS	36-007-04-PP	2
5	DECAL TERMINAL VEHICLE DETECTOR RECEIVER	36-026-01-PP	1
6	TIE STRAP 4" WHITE NYLON	44-561-14-PP	3
7	STRAIN RELIEF 1/4", c/w nut 3207	44-584-08-PP	2
8	CONNECTOR TERMINAL (MALE) MSTBHK 2.5mm 1765085	70-065-01-PP	1
9	CONNECTOR TERMINAL (FEMALE) MSTB2,5/10-ST 1754601	70-065-02-PP	1
10	PHOTO-EYE MTG BRACKET BANNER SMB30SC	70-080-09-PP	1
11	PHOTO EYE SHIELD	70-080-25-BK	1
12	PHOTO-EYE BANNER RECEIVER QS30RRX	70-080-31-PP	1
13	CRADLE MOUNT NYLON CM8	70-150-01-PP	3
14	ENCLOSURE BOX, IR110-2 LH	70-200-04-MP	1
15	WASHER FLAT SS #10	80-110-000-SN	4
16	LOCK WASHER #10 SS	80-910-000-SN	2
17	SCREW SS PAN-HD PHL #10-24 x 3/8"	83-510-006-SNC	7
18	SCREW PHL PAN-HD SS #10-24 x 3/4"	83-510-012-SNC	4

## 26-S10-00 RH LONG POST EXPLOSION

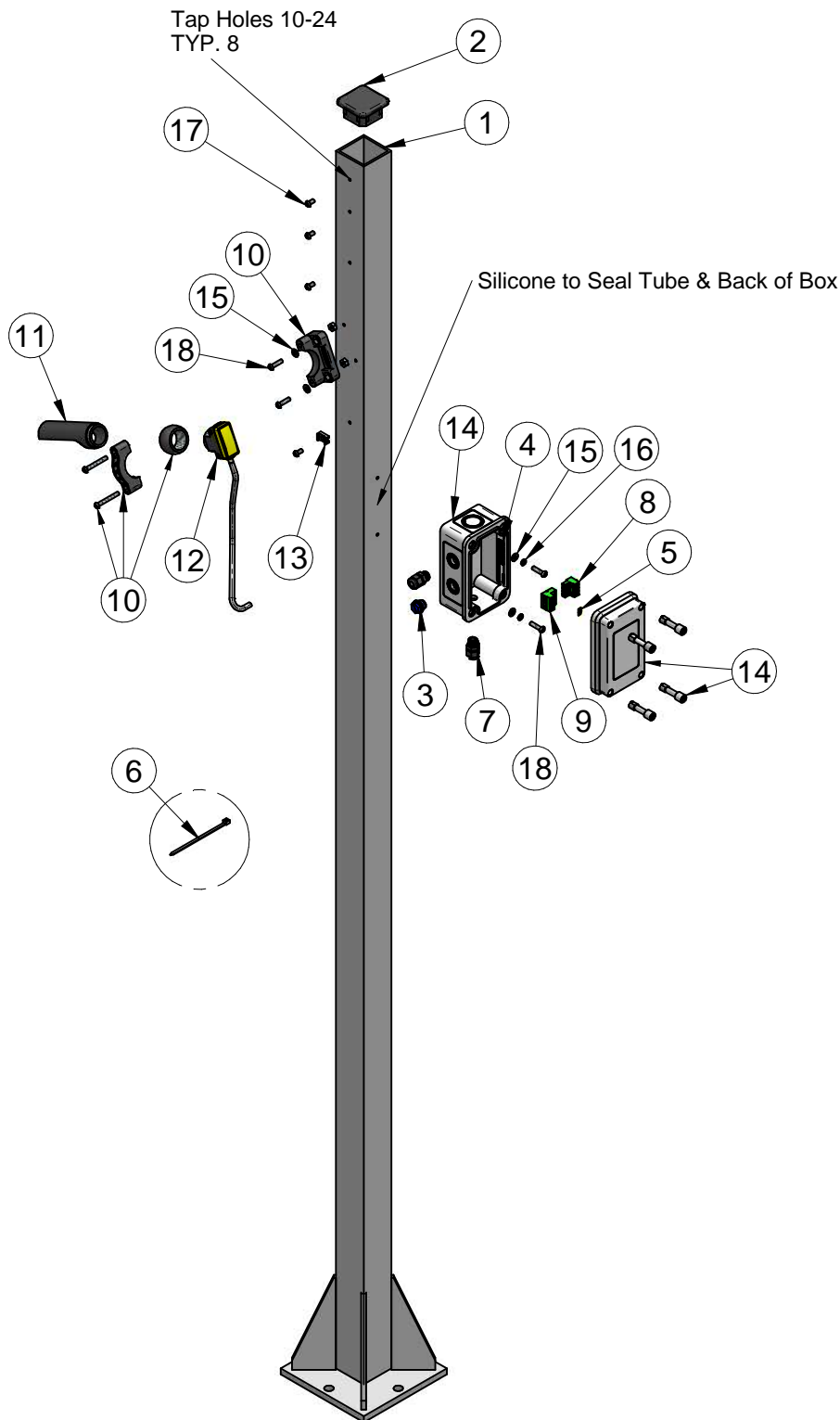

## 26-S10-00 RH LONG POST PARTS LIST

REF.	DESCRIPTION	PART NUMBER	QTY
1	VEHICLE DETECTOR POST-LONG AL	26-010-00-SG	1
2	2"x2" END CAP	26-015-00-PP	1
3	THREADED PLUG 1/2"-20 (B-4)	26-015-01-PP	1
4	DECAL TEST INSPECTION TAG FOR CONTROLLERS	36-007-04-PP	2
5	DECAL TERMINAL VEHICLE DETECTOR RECEIVER	36-026-01-PP	1
6	TIE STRAP 4" WHITE NYLON	44-561-14-PP	1
7	STRAIN RELIEF 1/4", c/w nut 3207	44-584-08-PP	2
8	4-POSITION FEMALE TERMINAL CON 1757035	70-026-01-PP	1
9	4-POSITION MALE TERMINAL CON 1786190	70-026-02-PP	1
10	PHOTO-EYE MTG BRACKET BANNER SMB30SC	70-080-09-PP	1
11	PHOTO EYE SHIELD	70-080-25-BK	1
12	PHOTO-EYE BANNER EMITTER QS30EX	70-080-30-PP	1
13	CRADLE MOUNT NYLON CM8	70-150-01-PP	1
14	JUNCTION BOX 5" X 3" X 3" VM533	70-200-05-MP	1
15	WASHER FLAT SS #10	80-110-000-SN	4
16	LOCK WASHER #10 SS	80-910-000-SN	2
17	SCREW SS PAN-HD PHL #10-24 x 3/8"	83-510-006-SNC	4
18	SCREW PHL PAN-HD SS #10-24 x 3/4"	83-510-012-SNC	4

26-S20-00 LH SHORT POST EXPLOSION

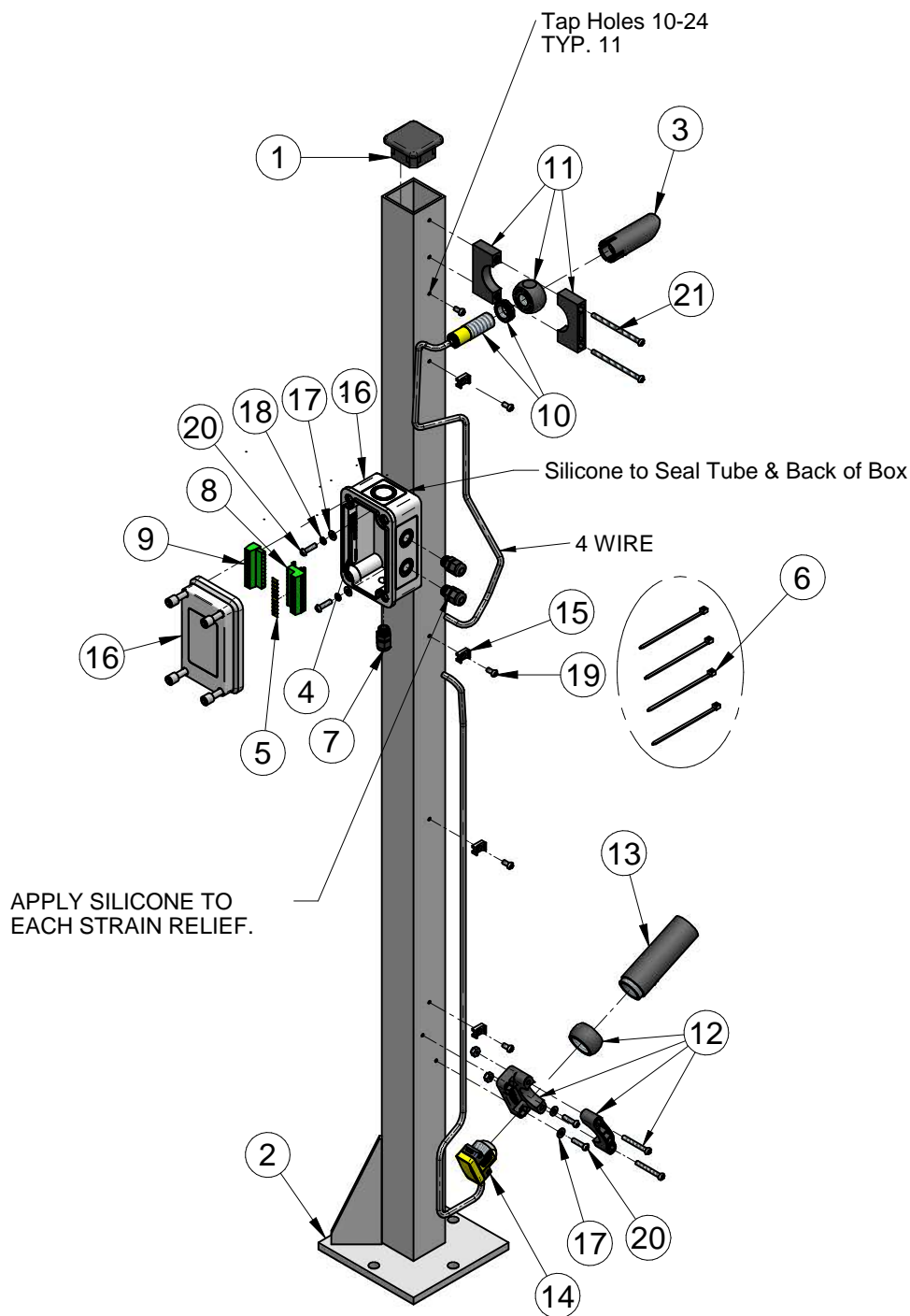

## 26-S20-00 LH SHORT POST PARTS LIST

REF.	DESCRIPTION	PART NUMBER	QTY
1	2"x2" END CAP	26-015-00-PP	1
2	VEHICLE DETECTOR POST-SHORT AL	26-020-00-SG	1
3	SENSOR PROTECTOR	26-030-01-BK	1
4	DECAL TEST INSPECTION TAG FOR CONTROLLERS	36-007-04-PP	2
5	DECAL TERMINAL VEHICLE DETECTOR RECEIVER	36-026-01-PP	1
6	TIE STRAP 4" WHITE NYLON	44-561-14-PP	4
7	STRAIN RELIEF 1/4", c/w nut 3207	44-584-08-PP	3
8	CONNECTOR TERMINAL (MALE) MSTBHK 2.5mm 1765085	70-065-01-PP	1
9	CONNECTOR TERMINAL (FEMALE) MSTB2,5/10-ST 1754601	70-065-02-PP	1
10	PHOTO-ELECTRIC SENSOR (RECEIVER) S18SN6R	70-080-05-PP	1
11	SENSOR MTG BRACKET CPZ18B03	70-080-08-PP	1
12	PHOTO-EYE MTG BRACKET BANNER SMB30SC	70-080-09-PP	1
13	PHOTO EYE SHIELD	70-080-25-BK	1
14	PHOTO-EYE BANNER RECEIVER QS30RRX	70-080-31-PP	1
15	CRADLE MOUNT NYLON CM8	70-150-01-PP	4
16	ENCLOSURE BOX, IR110-2 LH	70-200-04-MP	1
17	WASHER FLAT SS #10	80-110-000-SN	4
18	LOCK WASHER #10 SS	80-910-000-SN	2
19	SCREW SS PAN-HD PHL #10-24 x 3/8"	83-510-006-SNC	5
20	SCREW PHL PAN-HD SS #10-24 x 3/4"	83-510-012-SNC	4
21	SCREW PHL PAN-HD SS #10-24 x 3"	83-510-048-SNC	2

26-S20-00 RH LONG POST EXPLOSION

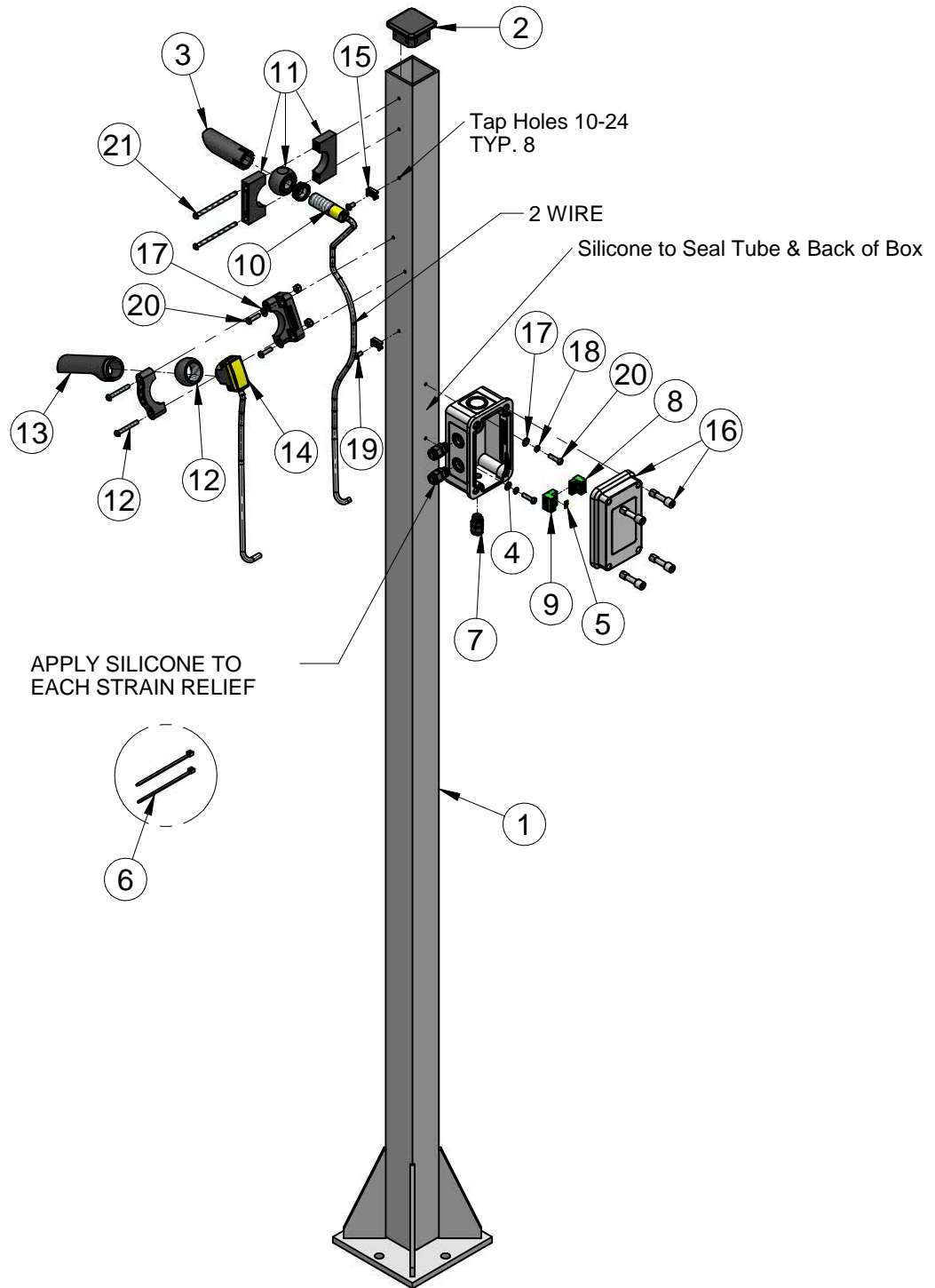



## 26-S20-00 RH LONG POST PARTS LIST

REF.	DESCRIPTION	PART NUMBER	QTY
1	VEHICLE DETECTOR POST-LONG AL	26-010-00-SG	1
2	2"x2" END CAP	26-015-00-PP	1
3	SENSOR PROTECTOR	26-030-01-BK	1
4	DECAL TEST INSPECTION TAG FOR CONTROLLERS	36-007-04-PP	2
5	DECAL TERMINAL VEHICLE DETECTOR RECEIVER	36-026-01-PP	1
6	TIE STRAP 4" WHITE NYLON	44-561-14-PP	2
7	STRAIN RELIEF 1/4", c/w nut 3207	44-584-08-PP	3
8	4-POSITION FEMALE TERMINAL CON 1757035	70-026-01-PP	1
9	4-POSITION MALE TERMINAL CON 1786190	70-026-02-PP	1
10	PHOTO-ELECTRIC SENSOR (EMITTER) S186E	70-080-06-PP	1
11	SENSOR MTG BRACKET CPZ18B03	70-080-08-PP	1
12	PHOTO-EYE MTG BRACKET BANNER SMB30SC	70-080-09-PP	1
13	PHOTO EYE SHIELD	70-080-25-BK	1
14	PHOTO-EYE BANNER EMITTER QS30EX	70-080-30-PP	1
15	CRADLE MOUNT NYLON CM8	70-150-01-PP	2
16	JUNCTION BOX 5" X 3" X 3" VM533	70-200-05-MP	1
17	WASHER FLAT SS #10	80-110-000-SN	4
18	LOCK WASHER #10 SS	80-910-000-SN	2
19	SCREW SS PAN-HD PHL #10-24 x 3/8"	83-510-006-SNC	2
20	SCREW PHL PAN-HD SS #10-24 x 3/4"	83-510-012-SNC	4
21	SCREW PHL PAN-HD SS #10-24 x 3"	83-510-048-SNC	2